



Apartment 2 6 Camden Drive, Birmingham, B1 3LS

£950 Per month



## Apartment 2 6 Camden Drive, Birmingham, B1 3LS

**£950 Per month**

New to the market, this modern one double bedroom apartment is located on the ground floor of the sought after Scholars Quarter development in the heart of the Jewellery Quarter, just a short walk from Birmingham city centre and numerous local amenities.

The property benefits from an entrance hallway with ample storage, leading into an open plan living / dining area with wooden flooring, stylish grey kitchen with integrated appliances, large double bedroom which is carpeted and a stylish luxury bathroom.

Offered on an unfurnished basis, with secure entry phone access and neutral decoration throughout.

\*Sorry, no allocated parking with this property.\*



## Description



## Situation



Unfurnished

Council Tax Band: C

Available: 14th July 2025

Floor Plans

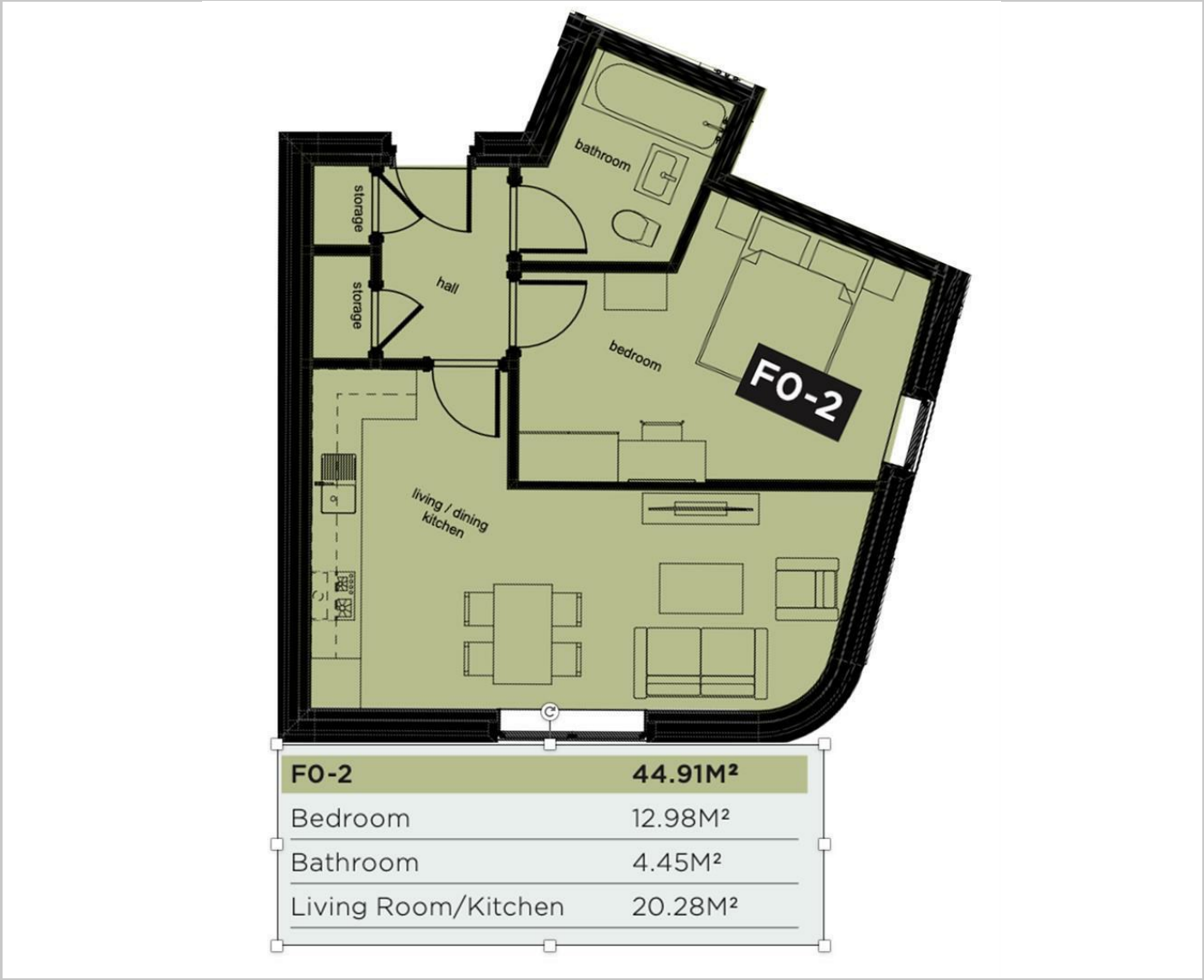

These particulars, whilst believed to be accurate are set out as a general outline only for guidance and do not constitute any part of an offer or contract. Intending purchasers should not rely on them as statements of representation of fact, but must satisfy themselves by inspection or otherwise as to their accuracy. No person in this firms employment has the authority to make or give any representation or warranty in respect of the property.

Area Map

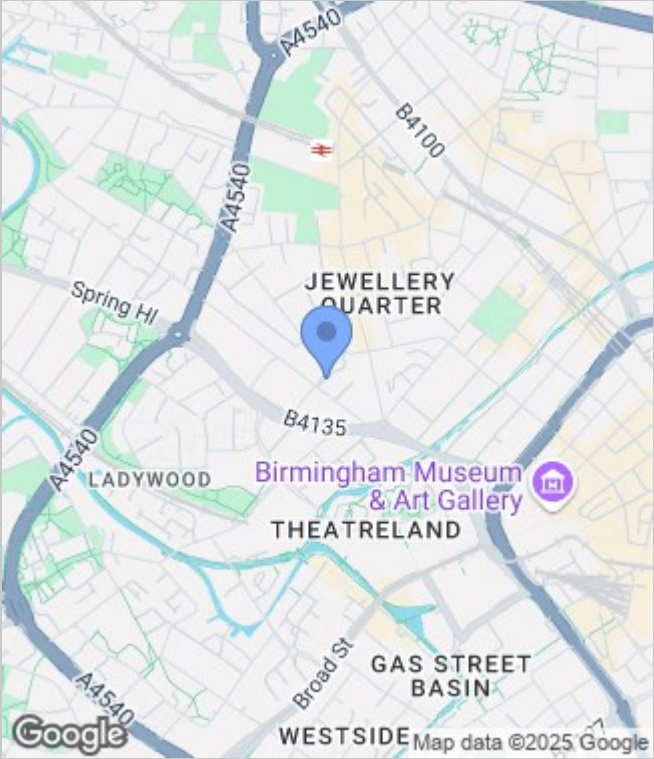

Energy Performance Graph

